

Optimum M4100

TERMINAL INSTALLATION GUIDE



COMPLIANCE

Changes or modifications not expressly approved by the party responsible for compliance could void the user's authority to operate the equipment.

- FCC ID: NVA00003, QIPMC56 (GSM)
This device complies with Part 15 of the FCC Rules. Operation is subject to the following two conditions: (1) this device may not cause harmful interference, and (2) this device must accept any interference received, including interference that may cause undesired operation. The user is cautioned that changes or modifications to the product(s) identified in this manual unless expressly approved by Hypercom could void the user's authority to operate these product(s).
- IC: 1204B-00003, 267W-MC56 (GSM)
- CE0682
- A-tick
- Wi-Fi: FCC ID: P1405W, IC: 1931B-WISM

World Headquarters:

Hypercom Corporation: 2851 West Kathleen Road | Phoenix, Arizona 85053, USA | Tel: +1.602.504.5000 | Fax: +1.602.504.4655

© 2007 Hypercom Corporation, all rights reserved. Hypercom and Optimum and Design are registered trademarks of Hypercom Corporation. The Hypercom logo is a trademark of Hypercom Corporation. All other products or services mentioned in this document are trademarks, service marks, registered trademarks or registered service marks of their respective owners. 940513-001 Rev. A 04/07

Optimum M4100

TERMINAL INSTALLATION GUIDE



 Optimum M₄₁₀₀



www.hypercom.com

Optimum M4100 Terminal Installation Guide

Equipment Check List →

WARNING:

- The battery pack is a Li-ion polymer battery which can explode if not properly replaced, handled or disposed of. Dispose of old batteries in accordance with local regulations. Use only batteries recommended by Hypercom as a replacement.
- Recharge only with Hypercom approved chargers designed for this product.
- Do not use if visibly damaged.
- Do not expose to temperatures above 140 °F or 60 °C.
- Do not disassemble.
- Do not short circuit battery pack terminals.
- Do not incinerate or crush.
- Keep out of reach of children and pets.



Optimum M4100

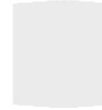

Screen Protector



Stylus



Terminal Battery

The Optimum M4100 terminal comes with a Lithium Battery Pack (3.6V 1150mAh). A fully charged battery can complete more than 200 transactions before requiring another charge.

NOTE: Charge the battery for 4-6 hours before initial use of the terminal.

Additional accessories are available for purchase. Contact your Hypercom Sales Associate for specific options and regional availability.

Inserting the Battery



Remove the battery from the packaging. Flip the terminal over (as shown).



Remove the battery cover from the terminal.



Insert the battery (as shown).



Reattach the battery cover. Turn the terminal on.

Charging the Terminal

(via Optional A/C Power Adapter Mini USB Cable)

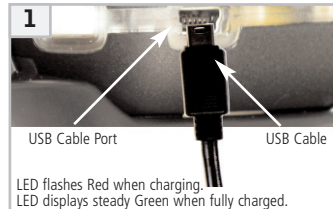

Insert USB cable end (as shown). Insert other cable end into an electrical wall outlet. Note: For optimal charge rate, keep terminal powered OFF while charging.

Powering the Terminal

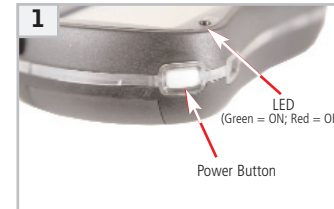

To turn ON, push & hold button until it beeps or green LED flashes (3-5 seconds). To turn OFF, push & hold button until it beeps or red LED flashes.

Using the Stylus



To use, remove stylus from its holder & press gently on the screen. When not in use, return stylus to its holder.

Accessories Available



Printer Module
(P/N# 010325-001)



Docking Station Module
(P/N# 010326-001)



Terminal Battery (Single Cell)
(P/N# 400036-001)



Printer Battery (Double Cell)
(P/N# 400036-002)

Accessories Available (continued)



Stylus
(P/N# 600504-001)



A/C Power Adapter
(P/N# 870065-002)



A/C Power Adapter
Mini USB Cable
(P/N# 870073-001)



RJ11 Cable
(P/N# 810005-010)



Large Carrying Case
(for terminal & printer only)
(P/N# 620002-001)



Small Carrying Case (for terminal only)
(P/N# 620002-002)



Screen Protector
(P/N# 700425-001)



Receipt Paper
(P/N# 710024-002)